



OF KETCHIKAN

2506 First Avenue
(907) 225.6191

www.RemaxofKetchikan.com

Whale Pass, Prince of Wales



This extremely well-built rustic wood interior cabin hosts a loft, full kitchen, and bath. Enjoy the ocean view from the nice deck area. A lovely spot to take in fishing, crabbing, and whale watching! The A-frame cabin is close to the beach. The bath house is not quite finished. The summer rental income is substantial and includes a vehicle for guests use. This is an amazing property!

| | | | |
|-------------|---|----------|-----------------|
| Price | \$160,000 | Name | Payne |
| Type | Single Family | MLS # | |
| Bedrooms | | Lot Size | 20,760 .48 acre |
| Bathrooms | | Roof | Metal |
| App.Sq.Ft. | 500 | Age | 2008 |
| Foundation | Post & Pad | Water | Cistern |
| Garage | | Zoning | |
| Heat | Woodstove | | |
| Legal Dscp. | Subdivision of Lot 21-A, Blk 9, ASLA No. 81 | | |
| Appliances | Refrigerator, microwave, hand pump | | |

List Agent Michal Beth Elerding, 617.0691

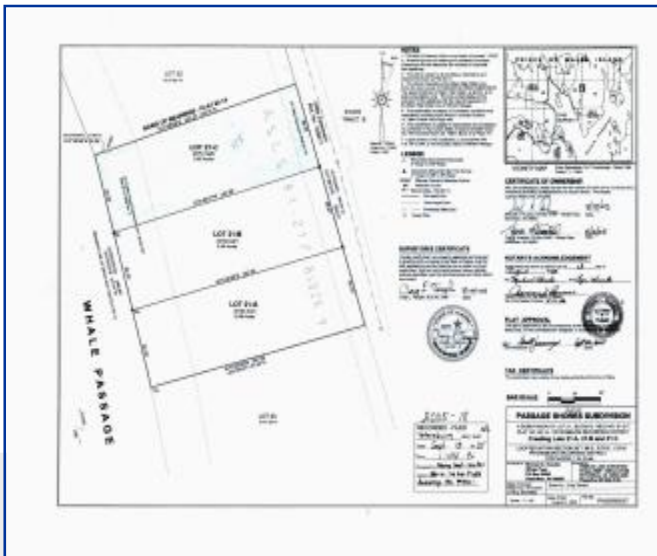

Equal Housing Opportunity

MLS

Property Information is collected in good faith and not guaranteed against errors.

